



TYPE EDM PUSH-BUTTONS



CONTROL AND SIGNALING SOLUTIONS FOR HARSH ENVIRONMENTS



TYPE EDM PUSH BUTTONS



Robust

Long life durability :

- A reliability recognized for more than 30 years
- Qualified according to nuclear standards IEEE 323 & 344
- A foolproof mechanical and electrical robustness
- Applications in harsh environments

Configurable

Adaptable to your applications :

- Available functions:
 - Momentary action button
 - Alternate action button
 - Indicator light
- Up to 4 stages equipped with 2 change-over contacts or 4 stages configurable at your request
- Illuminated , recessed, recessed protected push buttons...

APPLICATION

> Electrical equipment's control.

- These push-buttons have a particularly strong design which allows them very numerous applications in severe environments (shocks, vibrations, temperature, radiations, earthquakes).
- This range of product is a reference for more than 30 years in control room of nuclear power plants worldwide. It also equips very numerous electrical distribution plants and railways electrical dispatch.
- This range allows to realize all your functions of control push-buttons.

Codification of products

Presentation / Special assembly / Tab color / Escutcheon plate / Signaling and lamps / Function / Contacts scheme / Accessories //

Eg: EDML / - / 81 / - / L / 501 / 2000 / ST //

Presentation

EDME	Non-illuminated recessed push button Ø15 (Drilling Ø22,5) ; 110V contacts
EDM2E	Non-illuminated recessed push button Ø15 (Drilling Ø22,5) ; 220V contacts
EDMEP	Non-illuminated recessed , protected push button Ø15 (Drilling Ø22,5) ; 110V contacts
EDM2EP	Non-illuminated recessed , protected push button Ø15 (Drilling Ø22,5) ; 220V contacts
EDML	Illuminated projected push button Ø24 (Drilling Ø22,5) ; 110V contacts
EDM2L	Illuminated projected push button Ø24 (Drilling Ø22,5) ; 220V contacts
EDMLE	Illuminated recessed push button Ø24 (Drilling Ø22,5) ; 110V contacts
EDM2LE	Illuminated recessed push button Ø24 encastré (Drilling Ø22,5) ; 220V contacts
EDMLEP	Illuminated recessed , protected push button Ø15 (Drilling Ø22,5) ; 110V contacts
EDM2LEP	Illuminated recessed , protected push button Ø15 (Drilling Ø22,5) ; 220V contacts

EDME



EDMEP



EDML



EDMLE

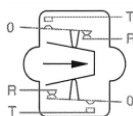
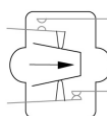

EDMLEP

110V
Contacts220V contacts
(1T+1R)

Codification of products

Presentation / **Special assembly / Tab color** / Escutcheon plate / Signaling and lamps / Function / Contacts scheme / Accessories //

Eg: EDML / - / 81 / - / L / 501 / 2000 / ST //

Special assembly

- C24** Product equipped with a special front part which allow to install it on a mosaic panel □24.(EDML only)
- C25** Product equipped with a special front part which allow to install it on our MAFELEC C25 mosaic panel □25.(EDML only)
- ESN** Black central nut (*in replacement of the standard chromed central nut*)
- SPE** Other special assembly or special realization at request

Tab color

EDML, EDMLE, EDMLEP

EDME

EDMEP

Color

81

90

98

White tab

81



85

91

95

Black tab

91



84

94

99

Yellow tab

83



83

93

97

Green tab

92



82

92

96

Red tab

Codification of products

Presentation / Special assembly / Tab color / Escutcheon plate / Signaling and lamps / Function / Contacts scheme / Accessories //

Eg: EDML / - / 81 / - / L / 501 / 2000 / ST //

Escutcheon plate

- 05** Square chromed escutcheon (for engraving) : □36 for EDME and EDML
- 06** Round chromed escutcheon (for engraving) : Ø36 for EDME and EDML
- 26** Round black escutcheon (for engraving) : Ø36 for EDME and EDML
- 62** Chromed protective plate (engrivable) Ø34 for EDMEP
- 72** Black protective plate (engrivable) Ø34 for EDMEP
- G** « G » in complement of PCC or PRC indicate that product is engraved
Engraving at your request

06G



26



62G



72G



Signaling and lamps

- Non-illuminated product or non-equipped with a lamp socket
 - L** Product equipped with an T5,5 socket for 1 lamp (Included in standard)
 - 48V** The voltage indicated in complement of socket type mean that the product will be supplied with a filament lamp working in this nominal voltage. The indication LED before the voltage mean that the product will be supplied with a white LED lamp working in this nominal voltage.
 - or**
 - LED48V**
- (products can be equipped with filaments lamps, white or colored LED lamps, for most common AC/DC nominal voltage)*

L



48V



LED48V



Codification of products

Presentation / Special assembly / Tab color / Escutcheon plate / Signaling and lamps / **Function / Contacts scheme** / Accessories //

Eg: EDML / - / 81 / - / L / 501 / 2000 / ST //

Function

501	Single impulse : momentary action
502	Push-Push : alternate action
950	Indicator light

Contact scheme

110V Contacts stages :

A push button can be equipped from 1 to 4 stages (2 to 8 change-over contacts). Standard contacts are in silver. For low current application the contacts can be in an gold-silver alloy : option Z in the accessories codification.

2000	1 stage of two 110 V change-over contacts
2200	2 stages of four 110 V change-over contacts
2220	3 stages of six 110 V change-over contacts
2222	4 stages of eight 110 V change-over contacts

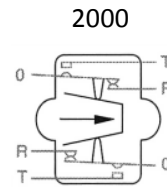
**220V Contacts stages** (3 types of stages available):

A push button can be equipped from 1 to 4 stages (beyond, consult us). 220V contacts are available in silver only.

Stage 2R :

Consisting of 2 Normally Close contacts.

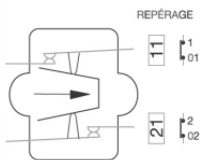
**Stage 2T :**

Consisting of 2 Normally Open contacts.

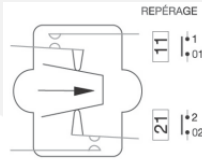
**Stage 1TR :**

Consisting of 1 Normally Open contact + 1 Normally Close contacts

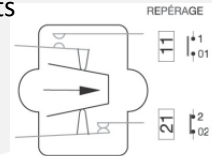

To define a 220V contacts configuration, you must combine the different types of stages.

Example 1 : 2R+2T = 2 stages push button, 1st stage 2R et 2nd stage 2T

Example 2 : 1TR+2R+2T = 2 stages push button, 1st stage 1TR, 2nd stage 2R, 3rd stage 2T



Codification of products

Presentation / Special assembly / Tab color / Escutcheon plate / Signaling and lamps / Function / Contacts scheme / Accessories //

Eg: EDML / - / 81 / - / L / 501 / 2000 / ST //

Accessories

- Z** Use of contacts in alloy Gold-Silver in replacement of contacts in alloy Silver/Nickel
(Recommended for low current level applications)
- ST** Plastic cable support for rear cable outlet (included in standard)
- STM** Metallic cable support for rear cable outlet
- SR** Resistance support (useful when you need to reduce the supply voltage of the lamp)
- CP** Plastic translucent contacts cover (IP20)

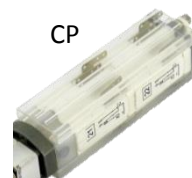
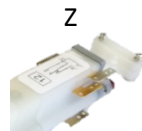

EDME-EDML-EDMLE push buttons

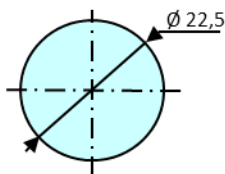

EDMEP-EDMLEP push buttons

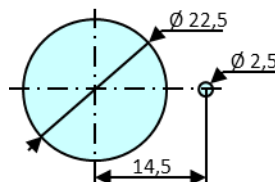

i Refer to installation guide for type E push-buttons for installation and maintenance.

Rear length

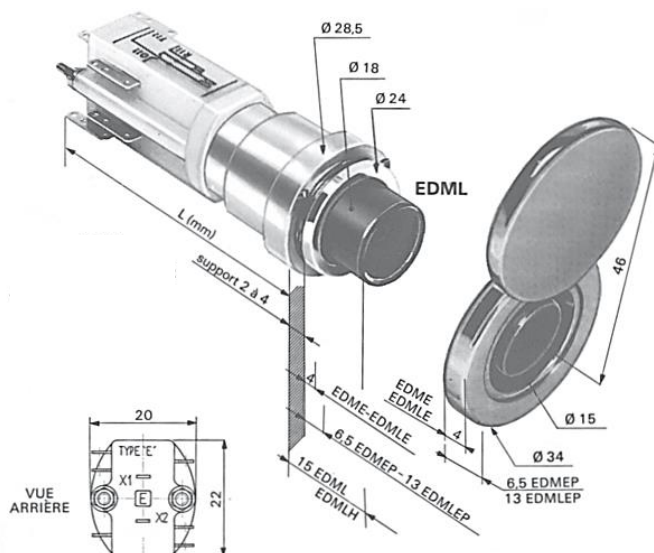

Function	L				ST	SR
	1 stage	2 stages	3 stages	4 stages		
501 Single impulse	77	108	139	170	+24	+28
502 Push-Push	97	128	159	190		

Electrical, mechanical, environmental characteristics

Electrical characteristics

Rated thermal current (I_{th})

4A

Dielectric strength

2000V-50Hz-
1min

Rated alternate current (I_e) (AC)

Standard silver contacts	110 V contacts				220 V contacts			
Rated working voltages (V)	<= 60		110 127		<= 60		110 127	
AC-11 (A)	4		3		4		3	
AC-21 (A)	4		4		4		4	
AC-22 (A)	4		4		4		4	
AC-23 (A)	4		4		4		4	
Rated direct current (Ie) (DC)								
Standard silver contacts	110 V contacts				220 V contacts			
Rated working voltages (V)	24	48	60	110 127	24	48	60	110 127
DC-11 (A)	2,5	0,8	0,6	0,2	3,2	1,2	0,8	0,2
DC-21 (A)	4	2,5	1,8	0,5	4	4	2,5	0,65
DC-22 (A)	3	1	0,7	0,2	4	1,5	1	0,25
DC-23 (A)	2	0,75	0,5	0,15	3	1	0,75	0,2

Minimum utilization characteristics

Standard silver contacts

5V-50mA

Special Gold/Silver contacts

1V-10mA

Maximum connection (Cu only)

Rigid or flexible cable

By soldering

Fast-On Clips : 2,8 X0,3

2 X 1 mm² max
1 mm²

Electrical, mechanical, environmental characteristics

Mechanical and environmental characteristics

Mechanical strength	500 000 cycles of semi-intensive operation
Fitting	By central nut on a 2 to 4 mm panel thick The device does not have to support the weight of the cables
Terminals protection level	IP00 (without cover) – IP2X (with cover)